

1
2
3
4
5
6
7
8
9
10
11
12
13
14
15
16
17
18
19
20

SECTION 2. King County Water District No. 119 is the appropriate entity to serve the area proposed to be annexed.

SECTION 3. Completion of this annexation does not constitute county approval or disapproval of any other permits, certifications or actions necessary to provide service to this annexation area.

INTRODUCED AND READ for the first time this 18th day of May, 1998.

PASSED by a vote of 12 to 0 this 22nd day of June,

19 98

KING COUNTY COUNCIL
KING COUNTY, WASHINGTON

Louise Miller
Chair

ATTEST:

Edwa Francis
Clerk of the Council

APPROVED this 30 day of June, 1998.

Donald Adams
King County Executive

Attachments: A. Legal Description
 B. Map

13222

**LEGAL DESCRIPTION
FOR
CHERRY GARDENS ANNEXATION AREA**

Beginning at the North Quarter Corner of Section 9, Township 26 North, Range 7 East of the W.M., King County, Washington; thence North $88^{\circ}27'35''$ West along the North line of said Section 9 a distance of 1,066.65 feet more or less to a point of intersection with the Northeasterly right-of-way line of NE 185th Place (Mountain View Road) and the true Point of Beginning of this description; thence North $60^{\circ}50'50''$ West a distance of 85.96 feet more or less to a point of intersection with the East right-of-way line of 312th Avenue NE; thence North $02^{\circ}13'20''$ West along said East right-of-way line a distance of 178.0 feet; thence East a distance of 1,120 feet; thence North $42^{\circ}43'40''$ West a distance of 10.37 feet; thence North $23^{\circ}43'10''$ West a distance of 229.32 feet; thence North $03^{\circ}30'00''$ East a distance of 592.37 feet more or less to the Northeast Corner of Lot 138 of Cherry Gardens Division No. 3 as recorded in Volume 22 on Page 26 of Plats, records of King County Washington; thence North $23^{\circ}07'10''$ East a distance of 396.87 feet to the Northeast Corner of Lot 137 of said Cherry Gardens Division No. 3; thence North $27^{\circ}56'10''$ East a distance of 356.54 feet to the Northeast Corner of Lot 136 of said Cherry Gardens Division No. 3; thence North $25^{\circ}25'40''$ West a distance of 348.79 feet to the Northeast Corner of Lot 2 King County Short Plat 579028-8003120509; thence West a distance of 1,281.71 feet to the Northwest Corner of said Lot 1 King County Short Plat and to a point of intersection with the East right-of-way line of 312th Avenue NE; thence North $02^{\circ}13'20''$ West along said East right-of-way line a distance of 108.57 feet; thence North $15^{\circ}01'10''$ West a distance of 44.82 feet; thence West a distance of 931.52 feet more or less to the Northeasterly Corner of Lot 132 of said Cherry Gardens Division No. 3; thence South $38^{\circ}15'20''$ West a distance of 919.73 feet more or less; to a point of intersection with the Southwesterly right-of-way line of NE 185th Place (Mountain View Road); thence South $32^{\circ}35'10''$ East a distance of 314.99 feet to the Northeasterly Corner of Lot 126 of said Cherry Gardens Division No. 3 and to a point of intersection of the Southwesterly right-of-way line of NE 185th Place (Mountain View Road) and Westerly right-of-way line of 310th Avenue NE; thence South $28^{\circ}00'40''$ West along the East property line of said Lot 126 a distance of 259.49 feet; thence South $01^{\circ}52'10''$ West along the East property line of said Lot 126 a distance of 802.50 feet; thence South $33^{\circ}33'00''$ East along the East property line of said Lot 126 a distance of 126.95 feet more or less to the Southeast Corner of said Lot 126 and to a point of intersection of the West right-of-way line of 310th Avenue NE and the North line of Section 9, Township 26 North, Range 7 East, W.M.; thence continuing South $33^{\circ}33'00''$ East along the Westerly right-of-way line of said 310th Avenue NE a distance of 355.87 feet; thence South $49^{\circ}04'20''$ East along said right-of-way line a distance of 327.27 feet; thence South $30^{\circ}53'20''$ East along said right-of-way line a distance of 425.61 feet; thence South $68^{\circ}26'20''$ East along said right-of-way line a distance of 173.31 feet; thence South $40^{\circ}18'00''$ East along said right-of-way line a distance of 485.12 feet more or less to the Southeast Corner of Lot 64 Cherry Gardens Division No. 2 as recorded in Volume 22 on Page 27 of Plats, records of King County, Washington; thence South $37^{\circ}07'20''$ West along the Southerly property line of said Lot 64 and Northerly right-of-way line of NE 178th Place a distance of 98.17 feet to an angle point on the Southerly line of said Lot 64; thence South $66^{\circ}20'00''$ West along the Southerly property line of Lot 64 and Northerly right-of-way line of NE 178th Place a distance of 117.26 feet; thence South $31^{\circ}46'15''$ East a distance of 520.51 feet; thence North $58^{\circ}13'45''$ East distance of 219.53 feet; thence South $82^{\circ}20'41''$ East a distance of 173.63 feet; thence South $51^{\circ}40'11''$ East a distance of 154.64 feet to the Northwesterly Corner of Lot 1 of Cherry Creek Heights Addition as recorded in Volume 72 on Page

12 of Plats, records of King County, Washington; thence North 35°26'05" East a distance of 112.72 feet more or less to a point of intersection with the Southerly right-of-way line of NE 178th Place and the Northerly Corner of said Lot 1 of Cherry Creek Heights Addition; thence continuing North 35°26'05" East a distance of 60.00 feet to a point on the Northerly right-of-way line of NE 178th Place; thence South 64°35'20" East along said Northerly right-of-way line a distance of 171.30 feet to the Southerly Corner of Lot A, King County Short Plat 274003-7411150510; thence North 45°00'00" East a distance of 552.31 feet to the Easterly Corner of said Lot A, King County Short Plat; thence North 45°00'00" West a distance of 352.50 feet to the Northerly Corner of Lot A of said King County Short Plat; thence South 45°00'00" West along the Northwesterly property line of said Lot A a distance of 49.03 feet to the Easterly Corner of Lot 1 of King County Short Plat 1279012-8006060573; thence North 46°44'07" West along the Northeasterly property line of said Lot 1 a distance of 362.17 feet to the Northerly Corner of said Lot 1 and the Easterly Corner of Lot 4 of King County Short Plat 980057-8101130585; thence North 51°11'34" West along the Northeasterly property line of said Lot 4 a distance of 321.77 feet to the Northerly Corner of said Lot 4 and Easterly Corner of Lot 3 of said King County Short Plat 980057-8101130585; thence North 55°40'11" West along the Northeasterly property line a distance of 362.26 feet to the Northerly Corner of said Lot 3 and Westerly Corner of Lot 1 of said King County Short Plat 980057-8101130585; thence North 45°00'00" East along the Northwesterly property line of said Lot 1 a distance of 532.0 feet more or less to the Northerly Corner of said Lot 1 and a point on the Southwesterly right-of-way line of NE 185th Place (Mountain View Road); thence North 60°50'50" West along said Southwesterly right-of-way line a distance of 289.0 feet more or less to a point of intersection with the North line of Section 9, Township 26 North, Range 7 East, W.M.; thence South 88°27'35" East along said North line of Section 9 a distance of 129.42 feet more or less to the true Point of Beginning of this description.

All of the above is located in King County, Washington.

msh\wd119\chergard\legal

CHERRY GARDENS ANNEXATION

TWP. 26 N., RGE. 7 E , W.M.

13222

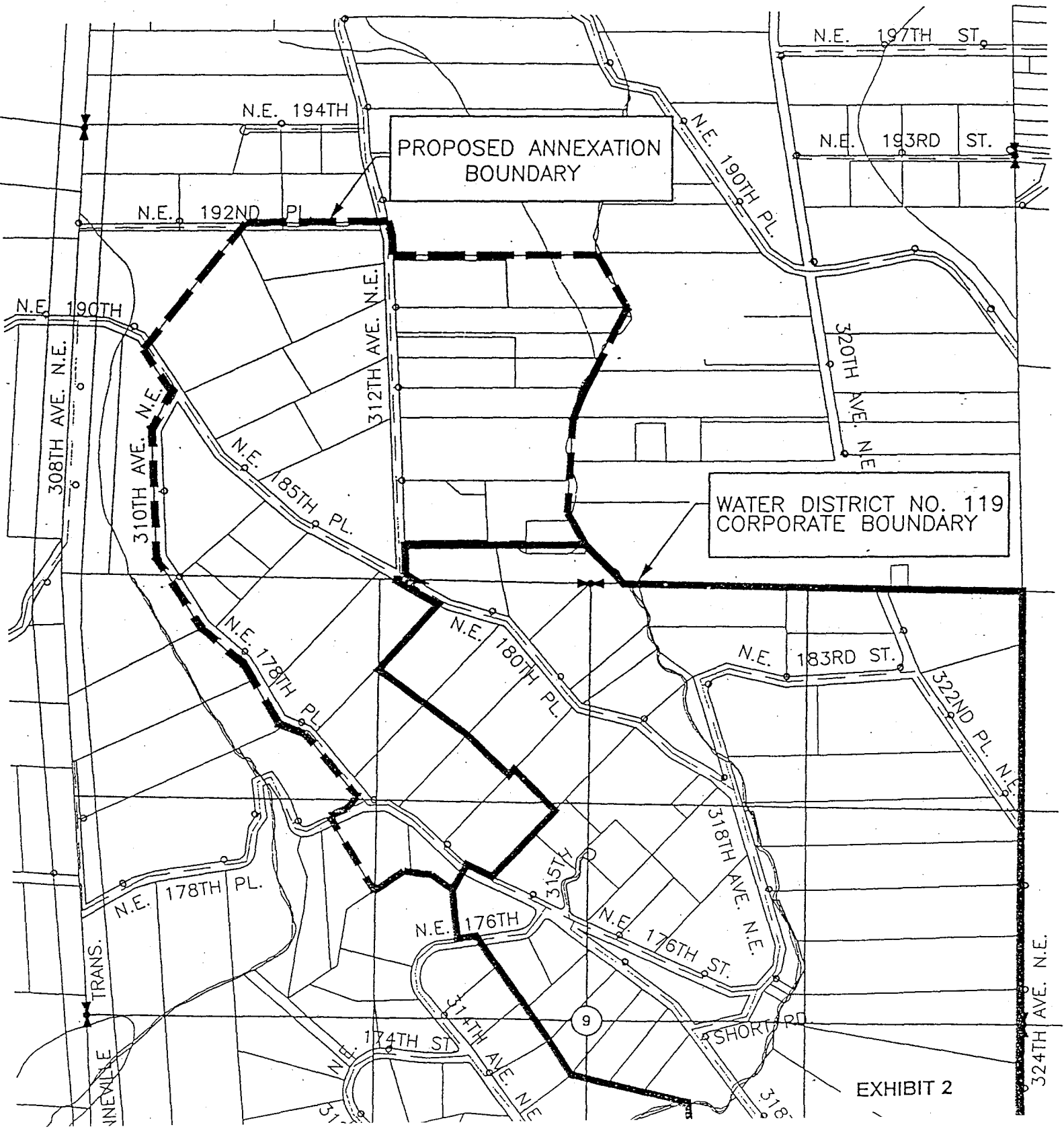
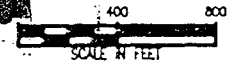

13222

SCALE: 2 INCHES

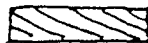

Annexation Area

WD 119 Corporate Boundaries

Fire District Boundaries

Urban Growth Area Boundaries

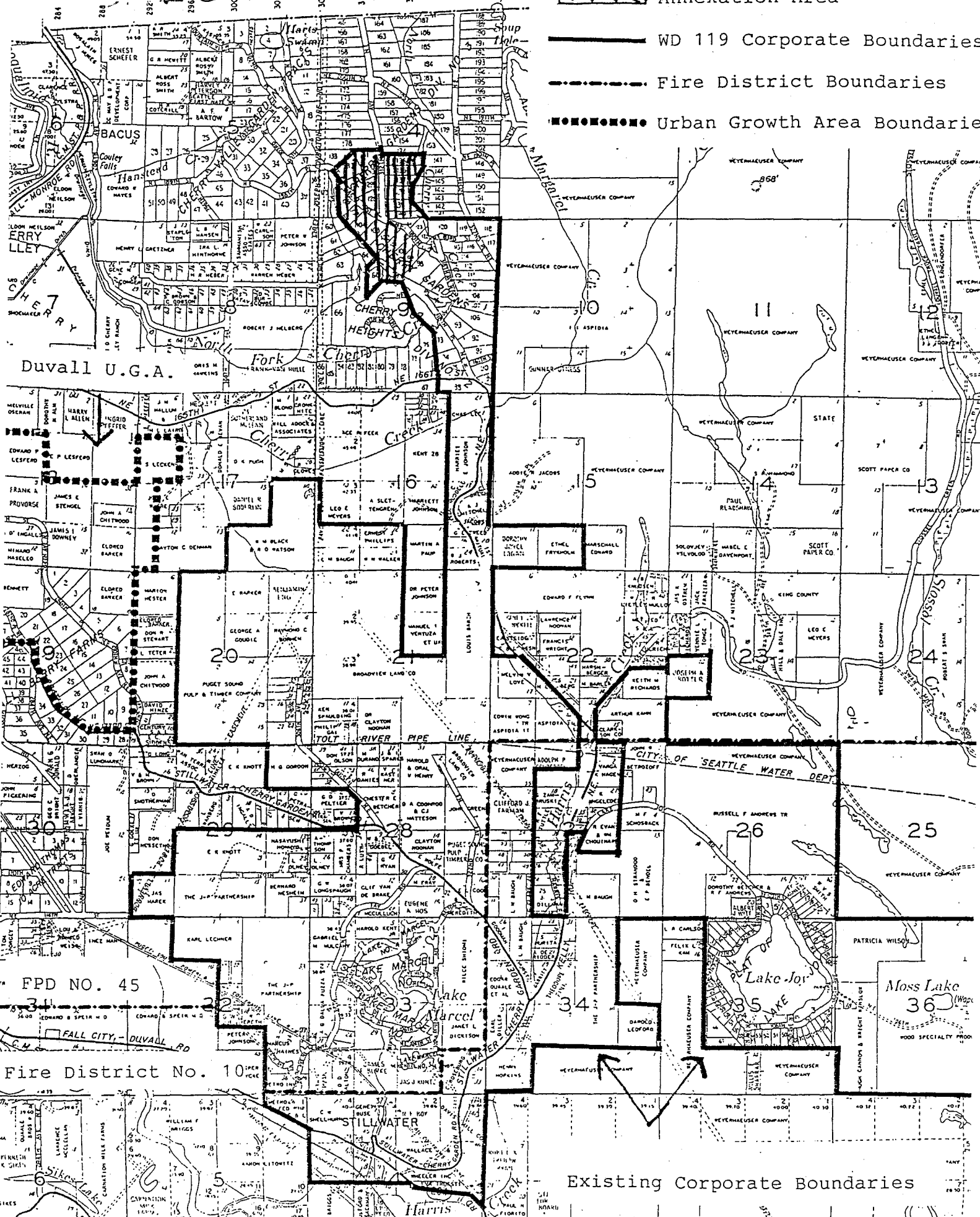

FPD NO. 45

FALL CITY - DUVALL RD

Fire District No. 10

Existing Corporate Boundaries